

## ◆ C001 Series Preloaded Piezo Actuator



### Features

- 2000N thrust
- Piezoelectric ceramics with lifetime of one billion cycles
- Open-Loop Resolution: 0.06nm
- Phosphor Bronze Housing, non-magnetic
- Simple structure, compact size
- Suitable for high vacuum environments to  $10^{-7}$ Pa

### Description

The PAPL-C001 Piezoelectric Actuator is a precision ceramic drive delivering direct conversion of electrical energy to linear motion. It features high resolution and large driving force, making it suitable for semiconductor equipment, medical devices, and other demanding applications.

### Applications

- Static and dynamic precision positioning
- Laser tuning

### Interface Definition

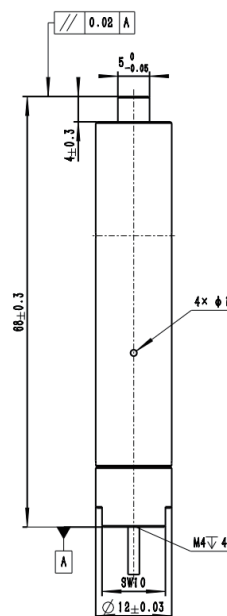

Default Output: Flat Push Head (customizable upon request)

## Technical Specifications

	PAPL-C001	Unit	Tolerance
Travel range at 150V*	60	μm	15%
Electrical capacitance**	6.2	μF	15%
Open loop resolution	0.06	nm	/
Integrated sensor***	/		/
Resonant frequency	11	kHz	15%
Stiffness	8.5	N/μm	15%
Push force****	1000	N	
Pull force	150	N	
Operating voltage	-20~150	V	/
Operating temperature range	-20~80	°C	/
Voltage connection	LEMO 00.250		/
Cable length	1.5	m	0.5%

\* Displacement output under no load;

\*\* Capacitance test conditions: ambient temperature environment, 500mVpp, 1kHz;

\*\*\* Parameters applicable only to the open-loop version of the piezoelectric preload actuator

\*\*\*\* Thrust test: drive voltage range 0 to 150V

Other specifications can be customized on request

## Customization Information

C001 series Preloaded Piezo Actuator, open-loop version

Type	Feature
PAPL-C001	C001 Preloaded Piezo Actuator: effective travel 60μm, open-Loop, non-magnetic, Suitable for high vacuum environments.