

## Heavy-Load Z Stage



### Features

- High stiffness and precision guide column
- High precision screw structure
- High load, high eccentricity resistance
- Full closed-loop servo design

### Description

The stage adopts innovative wedge design with a compact, low-profile. Through the high stiffness guide column and high precision screw structure, the platform has a very high positioning accuracy, repeatability and high load capacity.

### Applications

- Semiconductor
- Flat panel display
- Optical fiber alignment

### Interface Definition

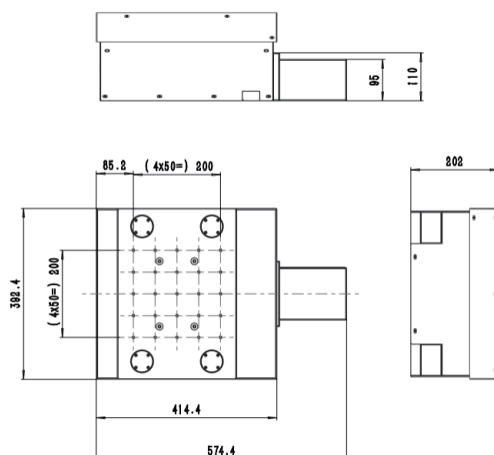

\*Interface dimensions from MZH400 in the middle of vertical stroke

## Technical Specifications

MZH400-25	
Travel range	25 mm
Max. velocity	20 mm/s
Max. acceleration	50 mm/s <sup>2</sup>
Accuracy	±1 μm
Bidirectional repeatability	±0.5 μm
Straightness	±3 μm
Pitch	100 μrad (21 arcsec)
Roll	100 μrad (21 arcsec)
Yaw	100 μrad (21 arcsec)
Orthogonality	100 μrad (21 arcsec)
<b>Mechanical properties</b>	
Moving mass (without payload)	23 Kg
Max. load	50 Kg
Stage mass	44 Kg
Dimensions	574.4 mm×392.4 mm×202 mm
Material	Aviation aluminum, black anodized

## Customization Information

The series is configured with options that can be selected based on the user's actual application. Options include travel, encoder, and more.

Table 1 Travel Options

-10	10mm travel displacement platform with servo motor and limit
-20	20mm travel displacement platform with servo motor and limit
-30	30mm travel displacement platform with servo motor and limit

Table 2 Encoder Options

-S1	Incremental analog optical linear encoder, 1Vpp
-S2	Incremental digital optical linear encoder, RS422
-S3	Absolute optical linear encoder, BISS