

## PMIN Piezo Motor Servo Controller 1~9 Axes



### Features

#### ■ Function:

- 1) Support 1~9 axes PMIN piezo motor servo control
- 2) Support incremental encoder, ABZ differential signal

#### ■ Interface:

- 1) Communication interface: RS-485 port/ Modbus RTU protocol, Ethernet/ Modbus TCP protocol
- 2) Motor interface: DB-37F per 3-axes motor servo control

### Description

C-LOX.3B controller is designed for PMIN series piezo motor driving, and can provide servo control based on external encoder positioning.

It supports incremental encoder (ABZ differential signal), and could achieve different motion velocity by changing output frequency.

Modularization design is applied and 1~9 driver could be used optionally.

### Interface Definition

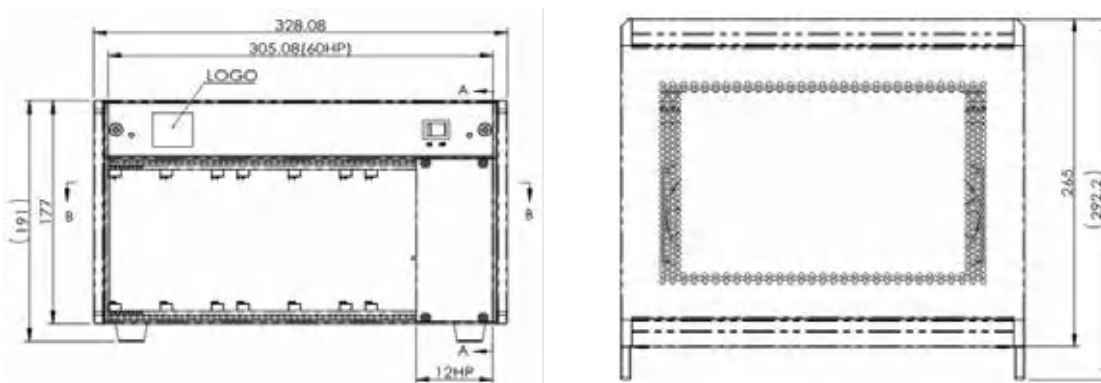

## Technical Specifications

Basics	C-LOX.3B	Unit
Function	Servo controller for PMIN series piezo motor	
Output voltage	0 to 70	V
Peak current / channel	500	mA
<b>Interfaces</b>		
Communication interface	RS485 / Modbus RTU	
Motor&Sensor interface	DB37 Female/3channels	
User software	PMIN Soft Panel	
<b>Miscellaneous</b>		
Operating voltage	AC 220	V
Max. power consumption	20 W per channel	
Operating temperature range	5~50	°C
Mass	8.5	kg
Dimensions	328×265×175	mm×mm×mm